

SPOHN RANCH SKATEPARKS

DESIGN CONCEPTS 2009

combining inspiration from the streets with the latest in concrete pre-casting, Spohn Ranch works with a rich palette of color, texture and form to create unique skate plazas worldwide.

by incorporating both real street and sculptural elements, a Spohn Ranch skate plaza inspires skaters, creating a positive feeling of ownership and stewardship.

while we continue to learn more about your project and site, we'd like to show you a bit of the inspiration we'll put into your project.



This is a rendering for Philippines-based skatepark incorporating local textures, colors and shapes. We'll find similar inspiration to create a plaza that honors your community.

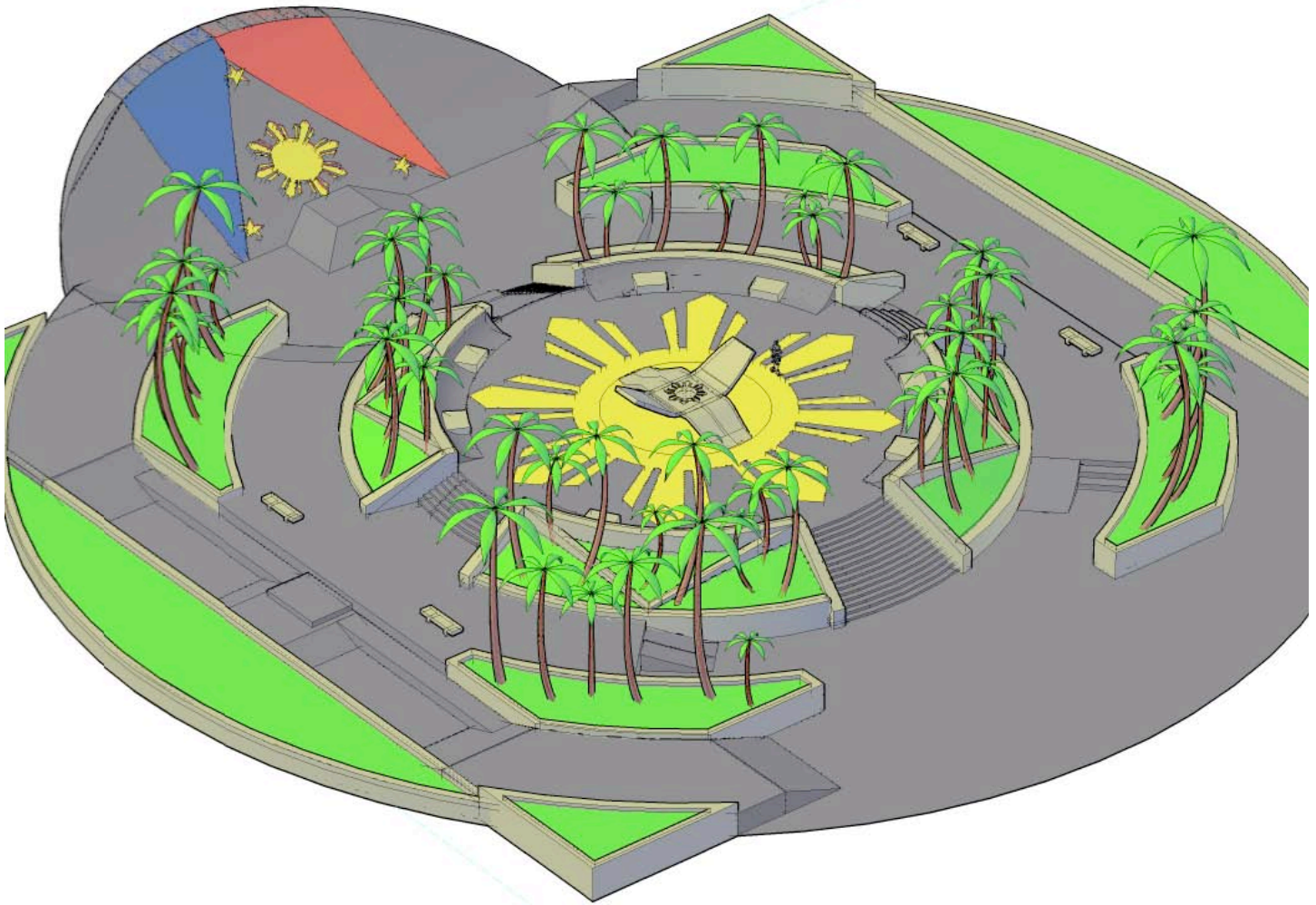

INTEGRATED LIGHTING

Pre-cast concrete allows for many forms and functions that poured-in-place cannot achieve. We can easily create hollow forms, cut-outs and shapes as well as integrate drains, lights, cables and other site elements.



COMBINING THE BEST OF ARCHITECTURAL METHODS WITH 20 YEARS OF SKATEPARK DESIGN EXPERIENCE



GRANITE LEDGES

Loved by skaters and architects, granite gives a custom, high-end touch to any skatepark. We have relationships with granite suppliers through-out the US and Canada to find the right stone for your park.



CUSTOM COLORS & TEXTURES

Our concrete pre-cast factory has over 50 years experience creating custom pieces.

Color-tinting, stamping and custom inlays are available in a wide array of styles



TRUE PLAZA DESIGN

While many skatepark designers prefer the transition style found in bowls, pools and snake runs, Spohn Ranch is one of the only major builders to specialize in skate plaza construction. Our recent experience working with one of the top street skaters in the world, Paul Rodriguez, on the recent LA Skate Plaza has created international attention.